

HOLE PUNCH PLIERS

ORDER #
3955TL

Metal Round Hole Hand Punch Tool

Powerful light weight hand punching tool for punching holes in all types of metals, develops a ton of punching power, accurate precision round holes in steel, aluminum, brass, copper, plastic, etc. with one hand.

Great for use where electricity or power are not available. Indoors or outdoors.

- Furnished with side gauge for depth adjustment, throat depth 2 inches
- Overall dimensions of hand tool: 8 $\frac{3}{8}$ inches long x 3 $\frac{7}{8}$ inches high
- Weight: 3.5 pounds
- Perfect balanced tool with curved handles for natural grip
- Will pierce up to 14 gauge mild steel

Hand-punch, these 7 most popular commonly used round hole sizes: $\frac{3}{32}$ inch, $\frac{1}{8}$ inch, $\frac{5}{32}$ inch, $\frac{3}{16}$ inch, $\frac{7}{32}$ inch, $\frac{1}{4}$ inch and $\frac{9}{32}$ inch. Extra punches and dies available.



Power Punch Kit

1. Die Key
2. Lower Throated Handle
3. Upper Pivot Handle
4. Pivot Arm
5. Assembly Side Plates
6. Pivot Arm Screw
7. Throat Depth Gauge
8. Pivot Pins
9. Installed Die
10. Punch in Proper Position for Installation

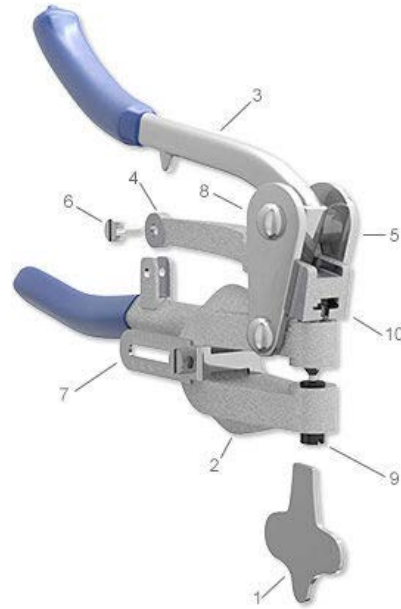

Punch and Die Installation Instructions

Dies are installed and replaced in lower throated handle (2) with use of die key (1). To replace punches remove the pivot arm screw (6) and lift the upper pivot handle (3) to position shown in the illustration. Then pull upper pivot handle (3) and pivot arm (4) back away from punch. Lift exposed and disengaged punch from punch hole guide.

To install punch reverse operation by placing new punch in punch hole guide and at the same time lining grooved sides of punch with slotted portion of pivot arm (4). Pull upper pivot handle (3) and pivot arm (4) with punch. Lower upper pivot handle (3) so that pivot arm (4) lines up with holes of lower throated handle. Insert pivot arm screw (6).

Maintenance and Safety Do's and Dont's

- Do oil frequently at pivot points, die and punch holes in lower throated handle, and punches and dies to avoid excess wear
- Do wear safety goggles
- Do use factory replacement parts, punches and dies only
- Do not use worn or damaged punches and/or dies
- Do not abuse or modify this tool
- Do not apply excessive force